

| | | |
|------------|--------------|---|
| DTC | P0770 | Shift Solenoid E Malfunction (Shift Solenoid Valve SL) |
|------------|--------------|---|

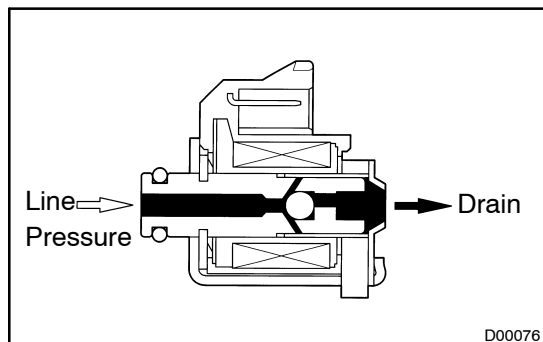

SYSTEM DESCRIPTION

The ECM uses the signals from the throttle position sensor, air-flow meter and crankshaft position sensor to monitor the engagement condition of the lock-up clutch.

Then the ECM compares the engagement condition of the lock-up clutch with the lock-up schedule in the ECM memory to detect mechanical trouble of the shift solenoid valve SL, valve body and torque converter clutch.

| DTC No. | DTC Detecting Condition | Trouble Area |
|---------|--|---|
| P0770 | Lock-up does not occur when driving in the lock-up range (normal driving at 80 km/h [50 mph]), or lock-up remains ON in the lock-up OFF range. (2-trip detection logic) | <ul style="list-style-type: none"> • Shift solenoid valve SL is stuck open or closed • Valve body blocked up or stuck • Lock-up clutch |

INSPECTION PROCEDURE

| | |
|----------|---|
| 1 | Check solenoid valve SL operation. |
|----------|---|

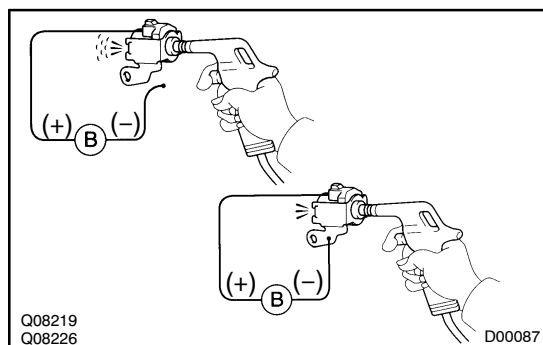

PREPARATION:

- Remove the oil pan.
- Remove the shift solenoid valve SL.

CHECK:

- Applying 490 kPa (5 kgf/cm², 71 psi) of compressed air, check that the solenoid valve opens.
- When battery voltage is supplied to the shift solenoid valve, check that the solenoid valve does not leak air.

NG

Replace the solenoid valve SL.

OK

| | |
|---|--|
| 2 | Check valve body (See page DI-179). |
|---|--|

NG

Repair or replace the valve body.

OK

Replace the torque converter clutch
(See page [AT-26](#)).